

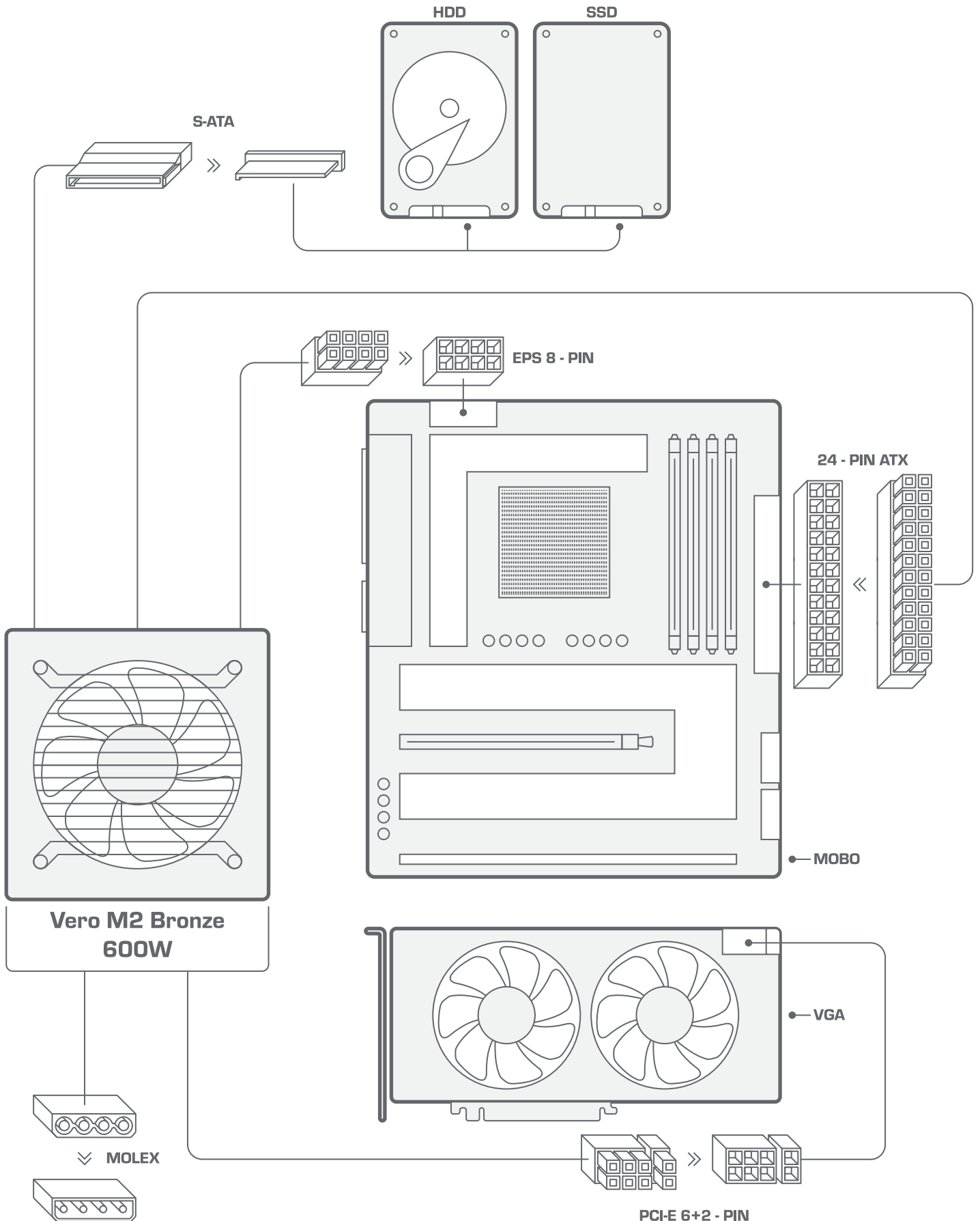

SILENTIUMPC

MANUAL

Vero M2 Bronze 600W



Vero M2 Bronze 600W

AC INPUT / WEJŚCIE 100~240V, 10-5A, 63Hz-47Hz Active PFC
ATX 12V 2.31 EPS 12V 2.91/2.92 and older

DC Output	+12V	+3.3V	+5V	-12V	+5VSB
Max A	49	15	15	0.3	2,5
Max W	588	100	3.6	12,5	
Total	600W				

